

DigaNET

MDVAR

MV13280 Operation Manual

Motion Detect Digital Video Audio Recorder



Instruction manual applies to the following model MV13280 please read carefully before operating

Instructions Before Using

Special Attention.....	03
Introduction.....	03
Various Uses	03
Packing List.....	03
Specifications	04
MV13280 At a Glance.....	04-05
SD Card Overview.....	05
Connection Diagram.....	06

Function Setup

The switch method of AV1 and AV2	06
Menu Image.....	07
Date/Time Setup.....	08
Motion Detect ON/OFF.....	09
Record AVI/Photo Setup.....	10
NTSC/PAL Setup.....	11
Image Quality Setup.....	12
Motion Detect Area.....	13
Motion Detect Count.....	14
Motion Detect Interval.....	15
Motion Detect Sensitivity 1	16
Motion Detect Sensitivity 2	16

Playback Operation

Playback Modes	17
Browse Six Thumbnail Pictures.....	18
Deleting	19
Formatting and Choosing Folders	20
Contacting Diganet.....	21
Notes	22-23
90 Day Limited Warranty	24

Special Attention

1. Connect all the parts before turning on the power.
2. Shut off the power when insert or pulling out the SD Card.
3. Static electricity can damage the SD permanently, so please do not touch the metal part of the SD Card
4. Please use special AC/DC adapter or battery.
5. Keep liquids away from the equipment.
6. Do not press buttons at the same time or abnormal operations may occur.

Introduction

The MV13280 is a new generation Two Channel Digital Motion Detection Video Recorder utilizing JPEG video compression. When motion is detected in the field of view of the camera the MV13280 can take snapshots and or record video automatically. The files are saved in an SD card. You can download the video/snapshots on to a PC for viewing and saving video files.

1. Once powered the MV13280 will begin recording based on motion detection and or taking snapshots.
2. When motion detection is not detected the MV13280 will stop recording and or taking snapshots.
3. The MV13280 can connect up to two cameras and record or take snapshots simultaneously.
4. The 2GB SD card will store video/ audio and snapshots.
5. "First in, First out" (FIFO). Files are automatically overwritten. Save the files on your PC that you do not want overwritten.

6. Supports CMOS and CCD cameras.
7. The video/audio/snapshot files will not be lost if you lose power.
8. NTSC/PAL Select NTSC in the USA.
9. The parameters such as date, time detection areas, sensitivity and interval time can be reset by user
10. The video files are an AVI format, and snapshots are JPEG.
11. User can search, browse and delete image files by date.
12. The MV13280 is also controlled by the IR remote.
13. Software is embedded in the MV13280. No additional software is required.

Various Uses

The MV13280 is easy to install, great performance, low cost and can interface with any camera, alarm, or other devices. The MV13280 is designed for the mobile environment but can also be used at home or business. Check with your insurance company as you may get a discount.

Packing List

1. MV13280
2. One DC5V power adapter
3. One special video output wire
4. One IR remote
5. One user manual

Specifications

Product model	MV13280
Work voltage	DC5V
Work current	≤ 300MA
Work temp	-10°C - +70°C
Maximum capability	2Gb
Photo format and pixel	JPEG 480x640
Video format and pixel	AVI 240x320
FPS/Second	10fps
Video record time	10sec/pc
Compress format	Motion JPEG
Record signal	1 channel Video
Motion detecting function	1-CH Video has Motion Detect function
Connected cameras	2 Camera (CMOS & CCD)
Video input	75Ω Typ.1vp-p
Video output	75Ω Typ.1vp-p
Mainframe Specification	124mmX110mmX26mm
Mainframe weight	250g
Remote control function	With the infrared remote control function

The DigaNET MV13280 obtains power from your car battery and depletes a nominal amount of milliamps. However you must start your car daily so you do not drain your battery. If you leave your vehicle unattended for more than 1 day you can use a spare battery to power your DigaNET.

MV13280 At A Glance

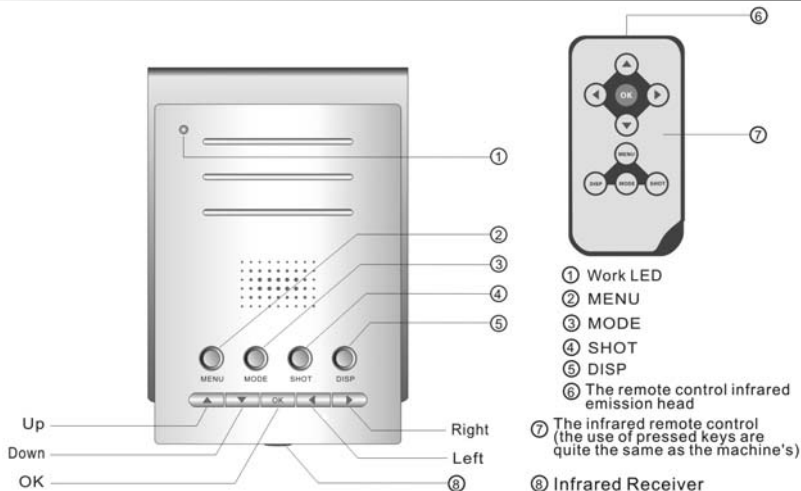

MV13280 At A Glance

Front Cover

- TV OUT
- Connect with Camera 1
- Connect with Camera 2
- DC12V Power

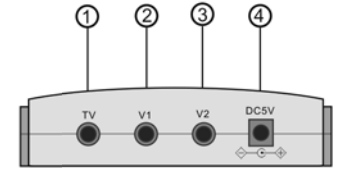

Back Cover



- Infrared Receiver
- Power ON/OFF
- SD CARD:SD Card slot

Remote Control Instruction

ATTENTION

The remote control should be pointed towards the MV13280 in order to operate.

Replacement Battery Model: CR2032 3V

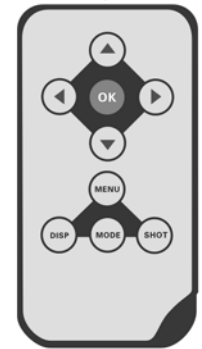

SD Card Overview

SD Card Installation

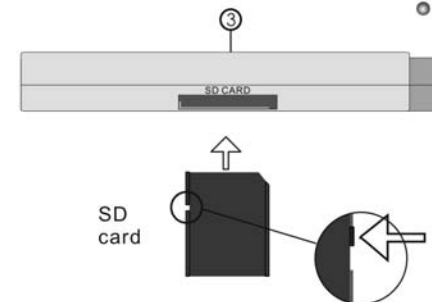

Insert SD card according to the picture above.

SD card Caution

- Static electricity can damage the SD Card. Please refrain from touching gold contacts
- Please turn off power when you insert or pull out SD card.
- It can support [FAT32].
- The MV13280 can support one 2GB SD card

Make sure write-protect tab is in the "write" position.

Connection Diagram

White Plug : Audio
 Yellow Plug: Video
 Black Plug : Power

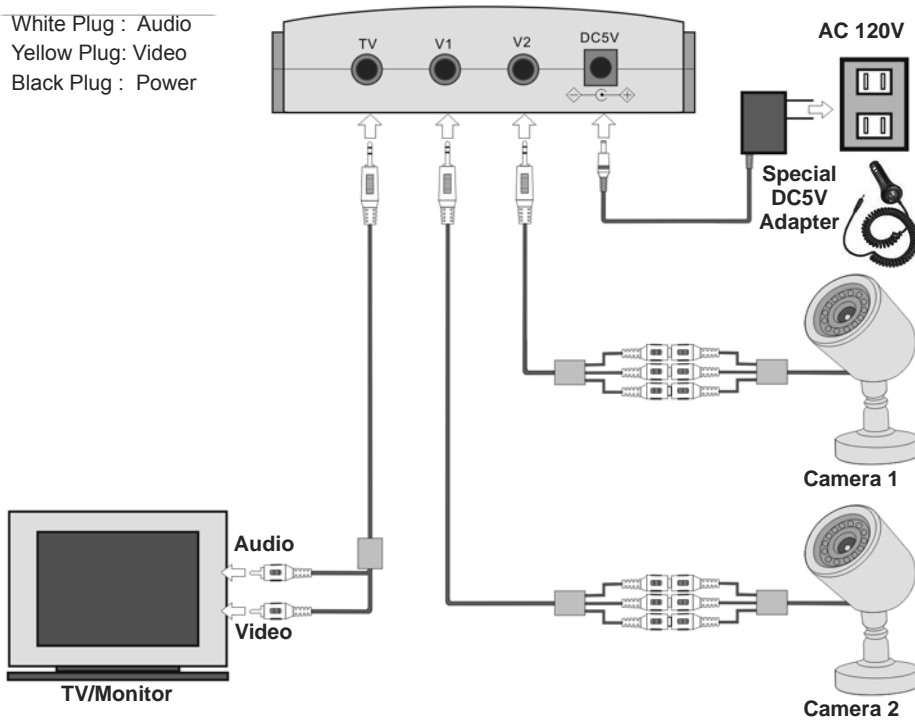

Switch AV1 & Av2

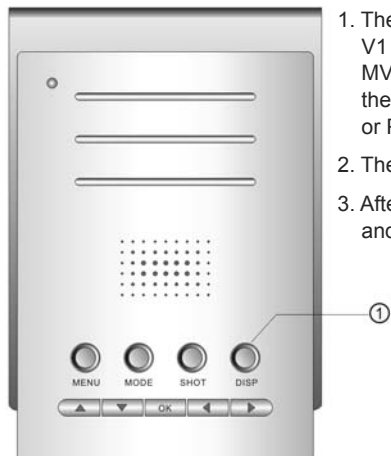

1. The MV13280 can connect with two cameras (V1, V2). V1 and V2 can function independently, however the MV13280 can only record the picture with one channel of the two cameras. The MV13280 can switch from V1 to V2 or PIP. You simply press the "Disp" key.
2. The MV13280 only records the main picture.
3. After starting the MV13280 one can switch between V1 and V2 or PIP. You simply press the D key.

Menu Image

Image setup1

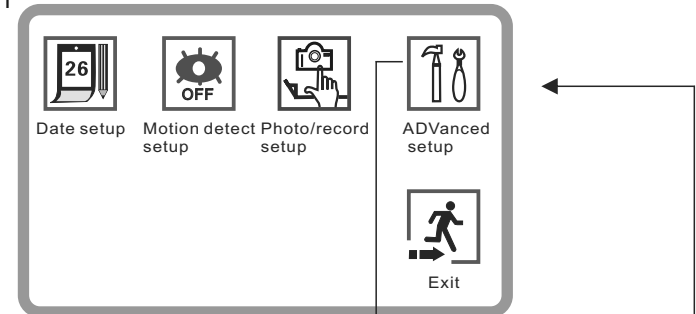
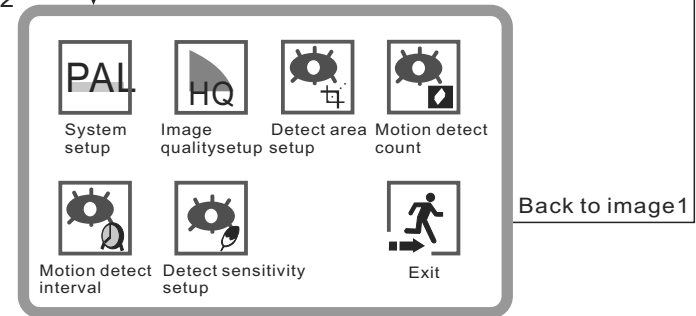
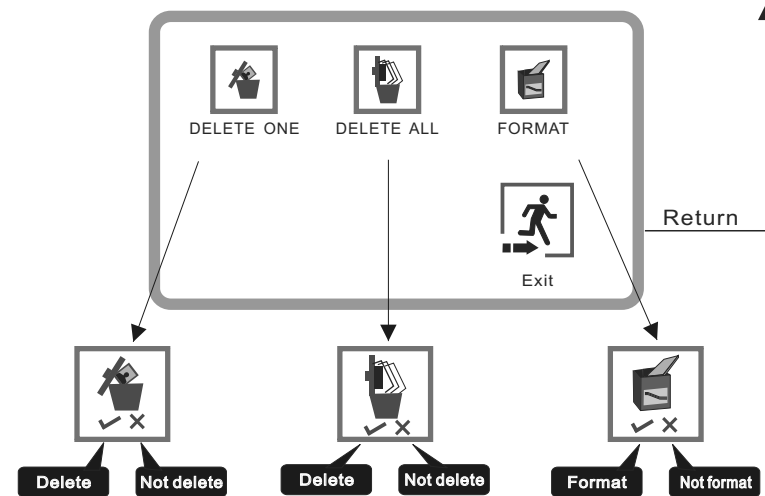

Image setup2



Delete operation



● When you choose " ✓, " ✗ will turn to green, then press OK to use delete function.

Date/Time Setup

(1) Press MENU to enter setup

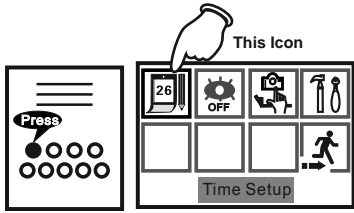

(2) Press LEFT/RIGHT to set date and then press OK.

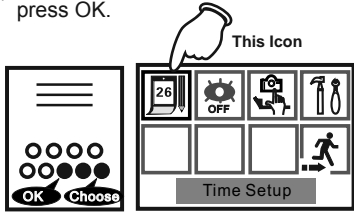

(3) Press LEFT/RIGHT to the needed option.

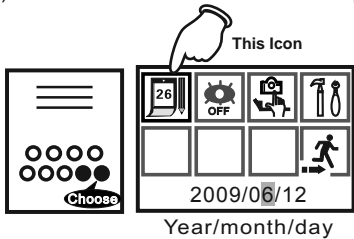

(4) Press UP/DOWN to set the date.

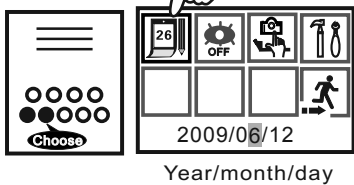

(5) After setting year/month/day, press RIGHT to set hour/minute/second.

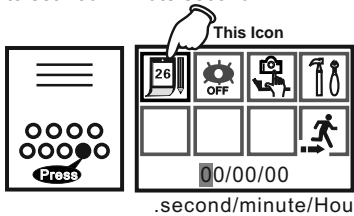

(6) Press UP/DOWN to set the time, and then press OK to confirm.

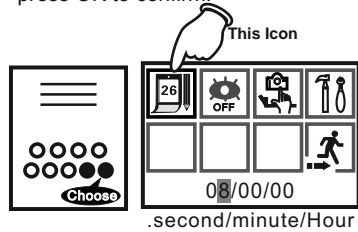

Exit Setup

(1) Press LEFT/RIGHT to exit option and then press OK.
 (2) Press MENU to exit directly.

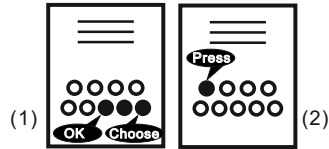

Motion Detect On/Off

(1) Press MENU to enter setup

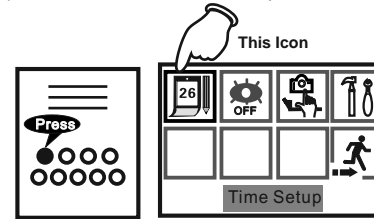

(2) Press LEFT/RIGHT to motion detect On/Off option.

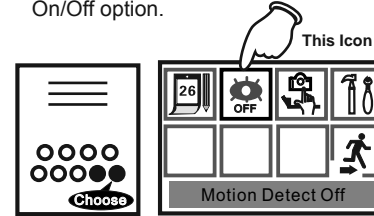

(3) Press OK to enter motion detect state.

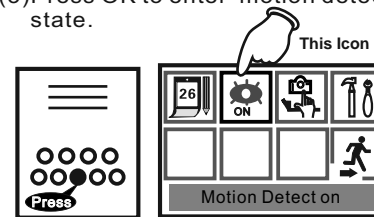

(4) Press OK again to motion detect off state.

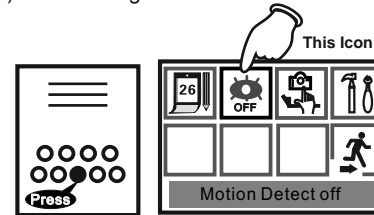

Exit Setup

(1) press LEFT/RIGHT to exit option and then press OK.
 (2) press MENU to exit directly.

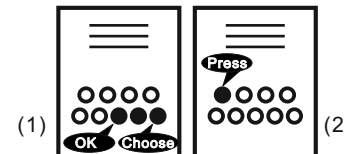

Motion Detect Quick Setup

Press UP Key directly can switch the motion detect state.

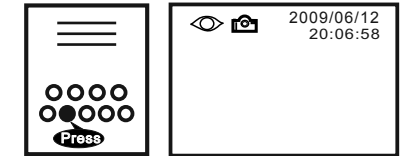

Motion Detect On



Motion Detect Off

Record AVI/Photo Setup

(1) Press MENU to enter setup

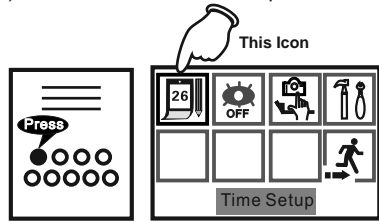

Photo/AVI quick setup

Press DOWN directly in the preview interface can switch the capture format photo/AVI.

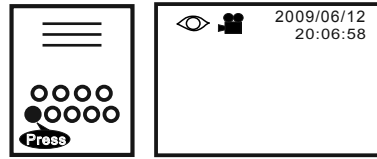

(2) Press LEFT/RIGHT to capture format AV/Photo option.

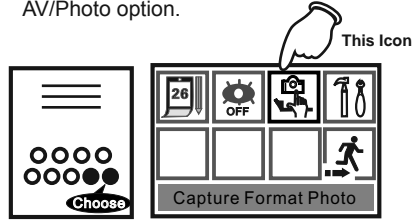

(3) Press OK to switch photo option.

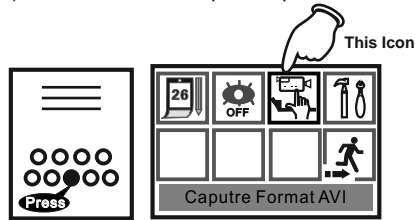

(4) Press OK to switch record option.

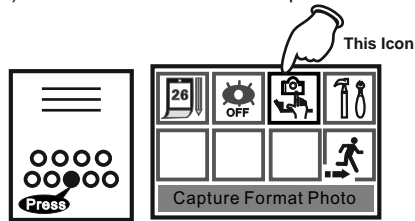

Exit setup

(1) Press LEFT/RIGHT to exit option and then press OK.
 (2) Press MENU to exit directly.

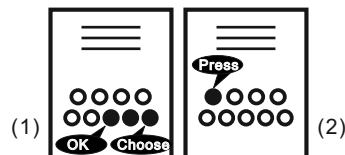

NTSC/PAL Setup

(1) Press MENU to enter setup

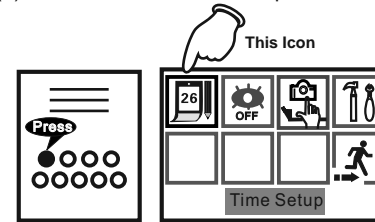

(2) Press LEFT/RIGHT to advance setup option, then press OK to confirm.

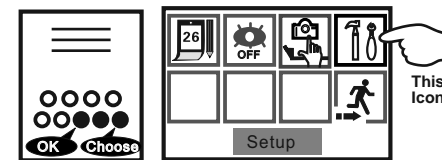

(3) Press LEFT/RIGHT to NTSC/PAL option, then press OK to confirm

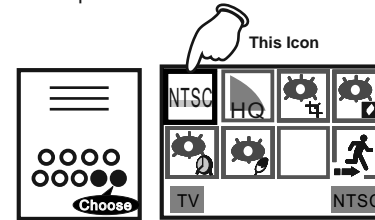

(4) Press OK to switch NTSC/PAL option.

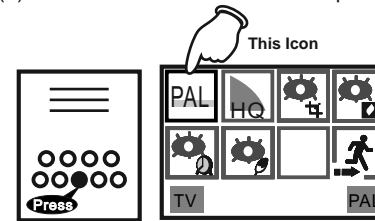

(5) Press OK to switch NTSC mode.

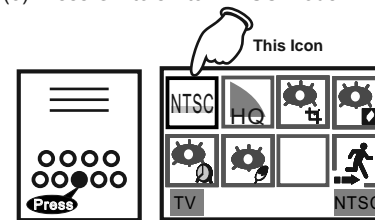

(6) Press LEFT/RIGHT to Exit option then press OK to exit.

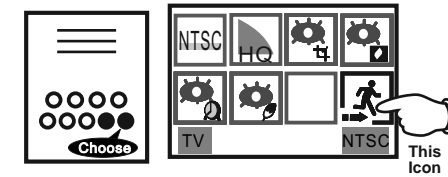

Exit Setup

Press MENU to exit directly.

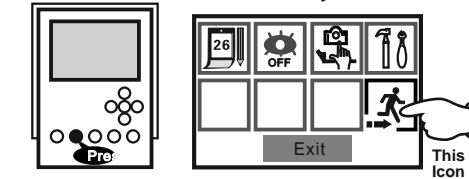
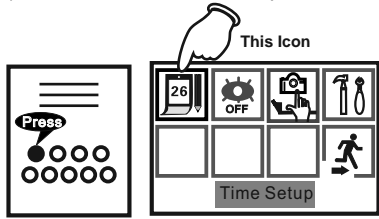
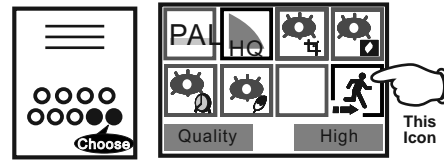

Image Quality Setup

(1) Press MENU to enter setup



(6) Press LEFT/RIGHT to exit option.



(2) Press LEFT/RIGHT to advanced setup option and then press OK to confirm.

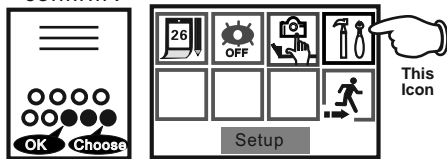

(7) Press OK to return to the setup.

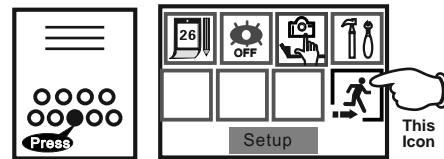

(3) Press LEFT/RIGHT to image quality setup option.

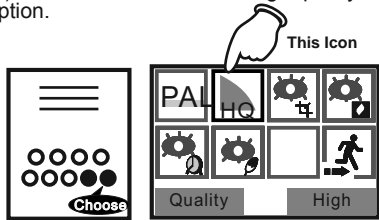

Exit Setup
Press MENU to exit directly.

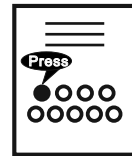

(4) press OK to switch High/Low image quality mode.

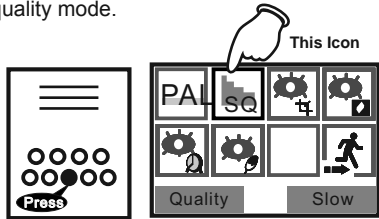

(5) press OK to switch High/Low image quality mode.

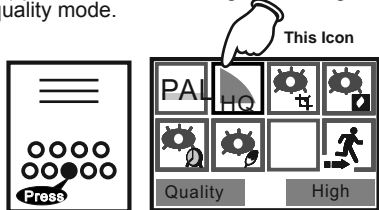

Motion Detect Area

(1) Press MENU to enter setup

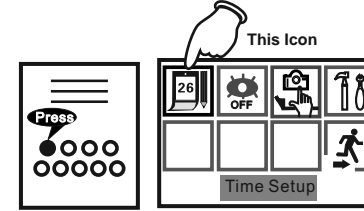

(6) Press UP/DOWN/LEFT/RIGHT to move detect area and then press OK to exit detect area setup.

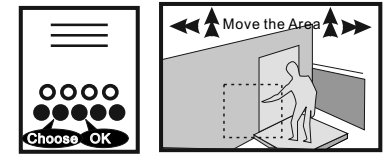

(2) Press LEFT/RIGHT to advanced setup option, and then press OK to confirm.

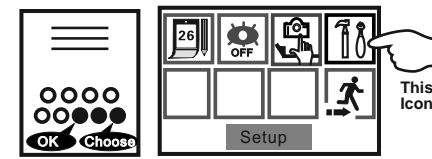

(7) Press LEFT/RIGHT to exit the option and then press OK to return to the setup.

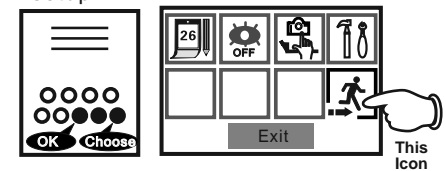

(3) Press LEFT/RIGHT to motion detect option.

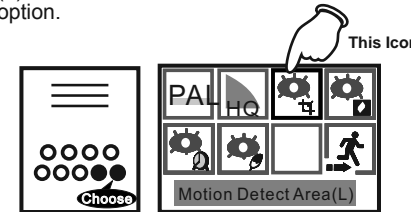

Exit Setup
Press MENU to exit directly.



(4) Press OK to motion detect area setup.

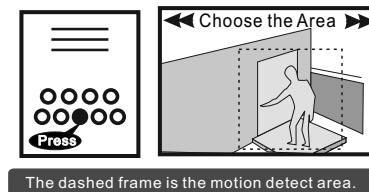

The dashed frame is the motion detect area.

(5) Press LEFT/RIGHT to choose detect area and then press OK.

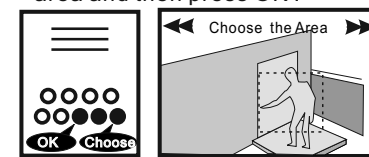

Detect area can divided into L/M/S

Motion Detect Count

MOTION DETECT COUNT means number of photos that you choose to take in one motion detect cycle. (User can choose 1/3/5 pics)

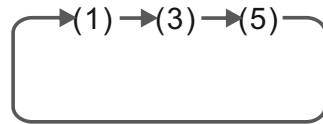

Can set 1/3/5 count

(1) Press MENU to enter setup

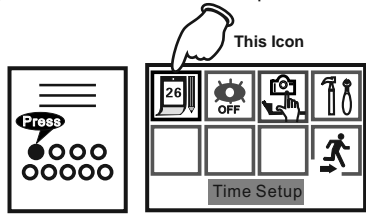

(5) Press LEFT/RIGHT to exit the option and then press OK to return to the setup .

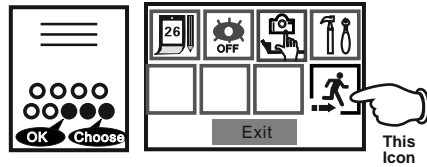

(2) Press LEFT/RIGHT to advanced setup option, and then press OK to advanced setup.

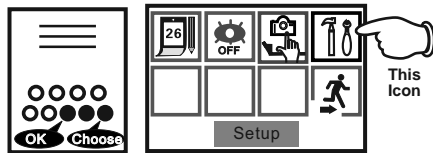

Exit setup
Press MENU to exit directly.

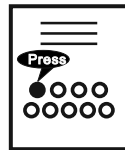

(3) Press LEFT/RIGHT to motion detect count option, and at the bottom of the screen shows the current count.

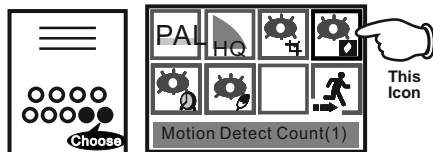

(4) Press OK to choose count number.

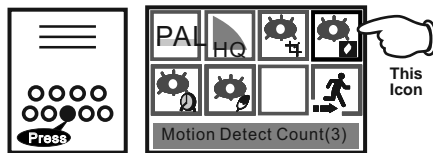

Motion Detect Interval

Motion detect interval means that you can set 1/3/5 seconds intervals between motion detection cycles

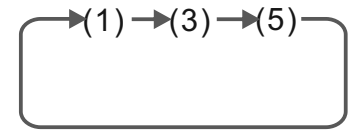

Can set 1/3/5 seconds time interval

(1) Press MENU to enter setup

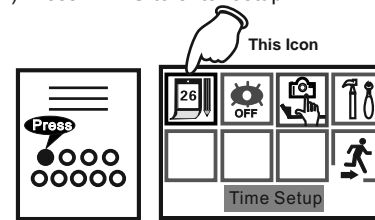

(5) Press LEFT/RIGHT to exit the option, and then press OK to return to the setup .

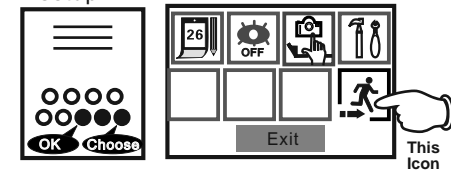

(2) Press LEFT/RIGHT to advanced setup option, and then press OK to confirm.

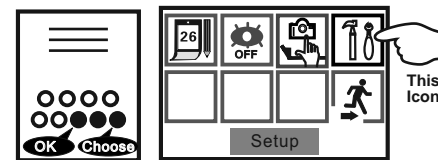

Exit Setup
Press MENU to exit directly.



(3) Press LEFT/RIGHT to motion detect interval setup option, and at the bottom of the screen shows the current interval.

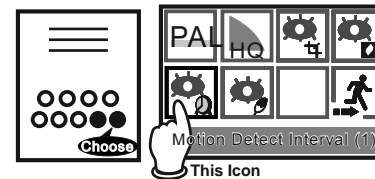

(4) Press OK to switch time .

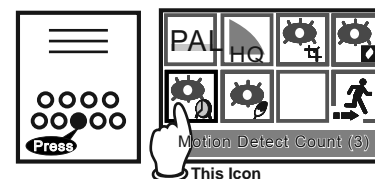

Motion Detect Sensitivity Settings

Setting 1

The motion detection sensitivity range is 01-99. The smaller the value is the higher the sensitivity. The higher the value is the lower the sensitivity.

(1) Press MENU to enter setup

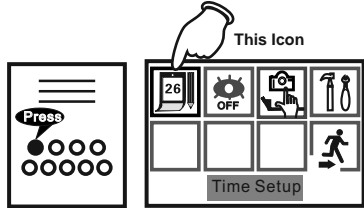

(2) Press LEFT/RIGHT to advanced setup option and then press OK to confirm.

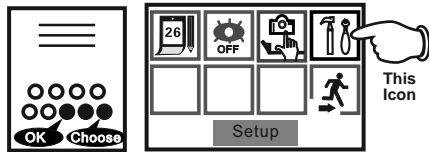

(3) Press LEFT/RIGHT to motion detect sensitivity option.

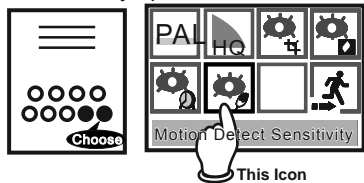

(4) Press OK to sensitivity setup interface and there are target value current value on the screen.

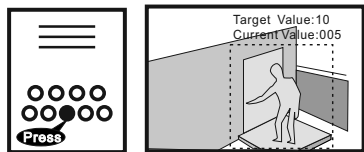

(5) Press UP/DOWN to set sensitivity and then press OK to return to the advanced SETUP.

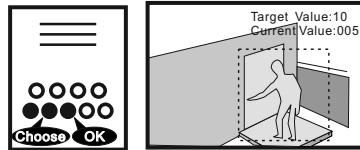

(6) Press LEFTT/RIGHT to exit option and then press OK return to SETUP.

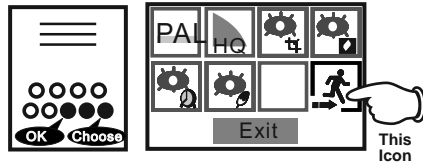

Exit Setup
Press MENU to exit directly.

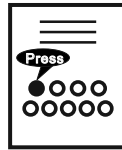

Setting 2

The graph below refers to motion detect sensitivity. When the "Current Value" reaches the "Target Value", the MDVAR will take a picture or record automatically.

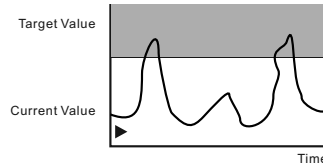

Motion detect sensitivity value setting will be different in different situation, the users can set proper sensitivity value according to the spot simulative test.

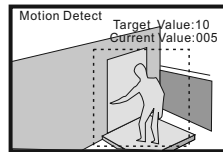

Playback Modes

The photos can be browsed by one through six thumbnails or by folder. Photos can be deleted one by one or you can delete all of them at once. You will need to format the SD Card

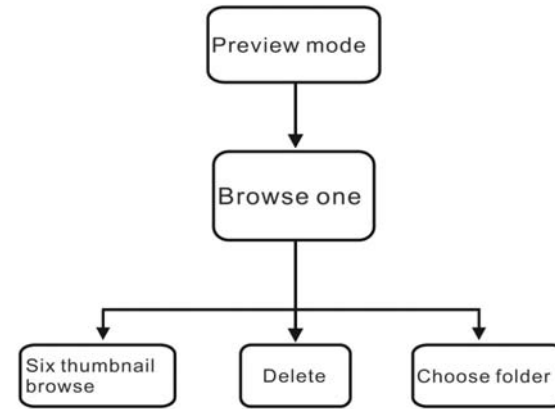

Operation under playback mode
Operation under playback mode

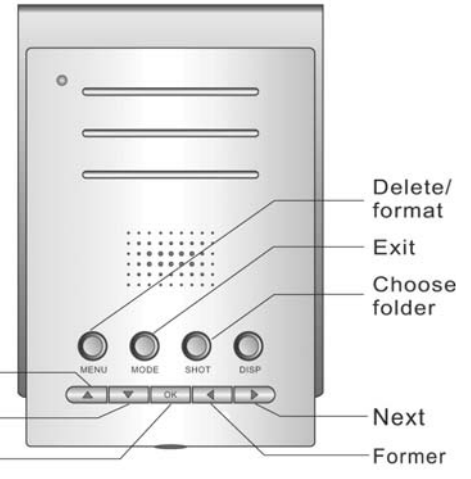

Prompt: The remote control can also carry on the operation completely.

1. Press MODE to playback interface in the preview mode and the current image information will be shown at the bottom of the screen.

2. Press MODE to return to the playback interface.

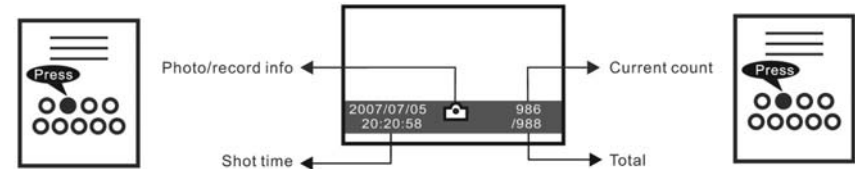

Browse Six Pictures

1. Press MODE to playback interface in preview MODE.



4. Press OK to see it in full screen.



2. Press OK to six thumbnail browse.

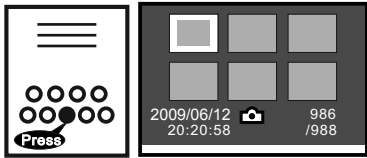

5. Press MODE to return to the playback interface.

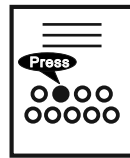

3. Press LEFT/RIGHT to select the pictures which you want to see.

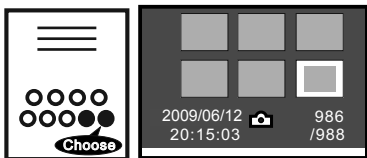

Operation on six thumbnail browse

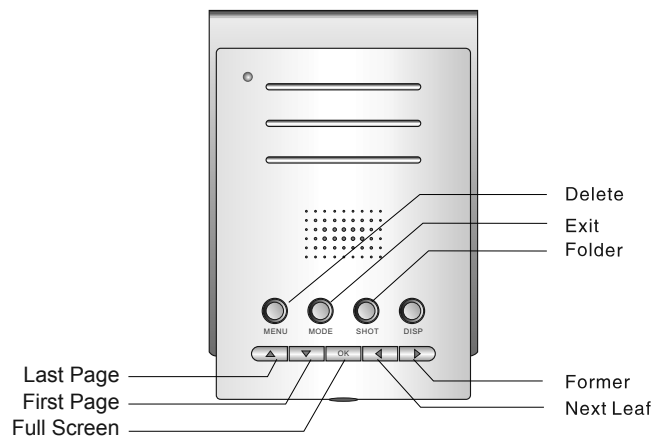

Deleting

(1) Press MODE to playback interface in preview mode



(2) Press MENU to delete

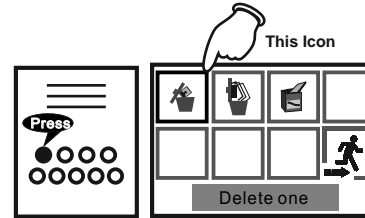

(3) Press LEFT/RIGHT to select DELETE ONE and then press, OK to confirm

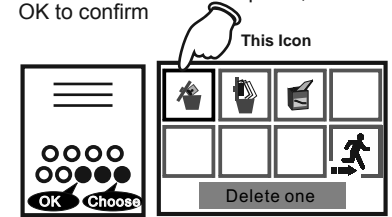

(4) Press LEFT/RIGHT to select DELETE or NOT DELETE option, and the press OK to confirm.

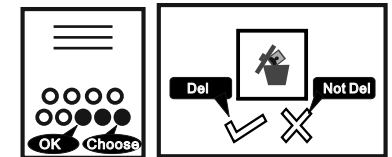

Formatting

(1) Press MODE to playback interface in preview mode.



(2) Press MENU to delete.

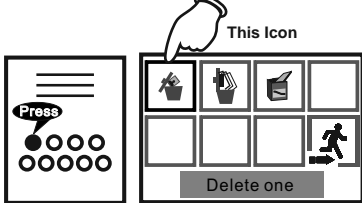

(3) Press LEFT/RIGHT to format and then press OK to confirm

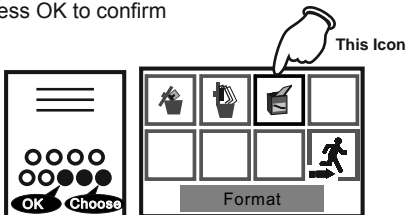

(4) Press LEFT/RIGHT to format or not format option, and then press OK to confirm.

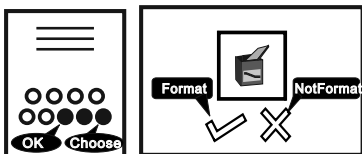

*Caution:Format will delete all the content in SD card.

Choosing Folders

(1) Press MODE to playback interface in preview mode.



(2) Press SHOT to choose folder .

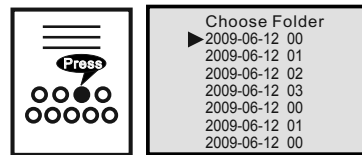

(3) Press UP/DOWN to select the folders you want to see and then press OK to confirm.

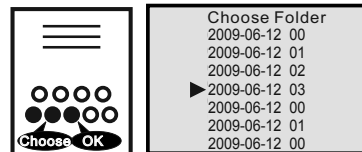

(4) The picture shows the photo in current folder.



Dear Customer,

Welcome to the world of DigaNET Mobile Digital Video/Audio Recorders.

If you ever obtain good video/audio of an incident please contact DigaNET at aibarra@diganet.net and we will send you a certificate worth \$40.00 on your next purchase of any DigaNET products.

We at DigaNET are excited about our affordable Mobile Digital Video Audio Recorders that will always give you digital video/audio when you need it!

DigaNET

2513 17th Street
 Denver, CO 80211
 888.344.6681 Voice
 303.455.9550 Fax
 aibarra@diganet.net

www.diganet.net

--

--

--

--

--

--

--

--

--

--

--

--

--

--

--

--

90 Day Limited Warranty

DigaNET

During the term of the Warranty, DigaNET will provide and upon demand, all repairs for the Equipment deemed necessary to keep the Equipment in good operational condition, except that DigaNET shall not be obligated to perform any repairs on the Equipment or any part thereof where the repairs are necessitated by carelessness or improper handling and use of the Equipment or any part thereof.

All parts needing replacement will be replaced without charge. With the exception of those parts damaged by carelessness or misuse and with the exception of the following:

Anything to the contrary herein notwithstanding, this Warranty does not cover work or replacement of parts made necessary by carelessness, misuse of the Equipment of any part thereof, or by accident where such carelessness, misuse or accident is caused by, your agents, employees, assignees or invitees, or by riots, floods, fire, wind, storm, earthquake, act of God, or other causes beyond its control. DigaNET shall not be liable for any loss or damage caused by defects or deficiencies in the Equipment. Furthermore, all responsibility and obligations of DigaNET under this agreement cease immediately if the Equipment is repaired or adjusted by any other than a representative authorized by DigaNET.